

# KT

## Inserts, small

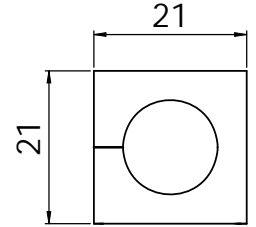

1

### Product description

KT cable inserts small are used with the following cable entry frames:

- KEL(-ER) | Page 6 - 14
- KEL-FG | Page 18 - 19
- KVT | Page 20 - 25
- KVT-W90 | Page 26

The model range KT small is designed for cable diameters from 2 to 17 mm.

### Assembly







When installing the insert, the smooth side of the insert faces the middle of the cable entry frame.

#### Specification KT grey

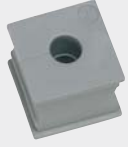
**Material** Elastomer  
**Flame class** UL94-Vo, self-extinguishing  
**Temperature** - 40°C to + 90°C (static)  
**Properties** Halogen-free, silicone-free

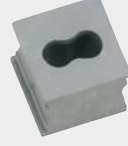
#### Specification KT black



**Material** Elastomer  
**Flame class** UL94-HB  
**Temperature** - 30°C to + 90°C (static)  
**Properties** Higher chemical resistance, UV-stabilized

Description	Type	Order No	Order No	Clamping range	PU	
		grey	black			
BTK		<input type="checkbox"/> 41251	<input checked="" type="checkbox"/> 41351	Blind insert	10	
KT		KT 2	<input type="checkbox"/> 39934	<input checked="" type="checkbox"/> 41302	2 - 3 mm	10
		KT 3	<input type="checkbox"/> 41203	<input checked="" type="checkbox"/> 41303	3 - 4 mm	10
		KT 4	<input type="checkbox"/> 41204	<input checked="" type="checkbox"/> 41304	4 - 5 mm	10
		KT 5	<input type="checkbox"/> 41205	<input checked="" type="checkbox"/> 41305	5 - 6 mm	10
		KT 6	<input type="checkbox"/> 41206	<input checked="" type="checkbox"/> 41306	6 - 7 mm	10
		KT 7	<input type="checkbox"/> 41207	<input checked="" type="checkbox"/> 41307	7 - 8 mm	10
		KT 8	<input type="checkbox"/> 41208	<input checked="" type="checkbox"/> 41308	8 - 9 mm	10
		KT 9	<input type="checkbox"/> 41209	<input checked="" type="checkbox"/> 41309	9 - 10 mm	10
		KT 10	<input type="checkbox"/> 41210	<input checked="" type="checkbox"/> 41310	10 - 11 mm	10
		KT 11	<input type="checkbox"/> 41211	<input checked="" type="checkbox"/> 41311	11 - 12 mm	10
		KT 12	<input type="checkbox"/> 41212	<input checked="" type="checkbox"/> 41312	12 - 13 mm	10
		KT 13	<input type="checkbox"/> 41213	<input checked="" type="checkbox"/> 41313	13 - 14 mm	10
		KT 14	<input type="checkbox"/> 41214	<input checked="" type="checkbox"/> 41314	14 - 15 mm	10
		KT 15	<input type="checkbox"/> 41215	<input checked="" type="checkbox"/> 41315	15 - 16 mm	10
		KTs 16	<input type="checkbox"/> 39901	<input checked="" type="checkbox"/> 39912	16 mm	10
		KTs 17	<input type="checkbox"/> 39900	<input checked="" type="checkbox"/> 39913	17 mm	10
		KT oval		<input type="checkbox"/> 39930	-	approx. 8 × 4 mm
KT S1		<input type="checkbox"/> 39931	-		10	
KT tele		<input type="checkbox"/> 39929	-	Telephone cable	10	
KT tele1		<input type="checkbox"/> 41257	-	Data cable RJ12	10	
KT tele2		<input type="checkbox"/> 41258	-	Data cable RJ10 / RJ45	10	

# KT Inserts, small



Type	Order No grey	Order No black	Clamping range	PU	Description
------	---------------	----------------	----------------	----	-------------

KT 2 2	<input type="checkbox"/> 39935	<input checked="" type="checkbox"/> 39936	2× Ø 2 mm	10	 KT 2 x
KT 2 3	<input type="checkbox"/> 39939	<input checked="" type="checkbox"/> 39940	2× Ø 3 mm	10	
KT 2 4	<input type="checkbox"/> 39906	<input checked="" type="checkbox"/> 39907	2× Ø 4 mm	10	
KT 2 5	<input type="checkbox"/> 41200	<input checked="" type="checkbox"/> 39904	2× Ø 5 mm	10	
KT 2 6	<input type="checkbox"/> 41201	<input checked="" type="checkbox"/> 39905	2× Ø 6 mm	10	
KT 2 7	<input type="checkbox"/> 41202	<input checked="" type="checkbox"/> 39916	2× Ø 7 mm	10	
KT 2 8	<input type="checkbox"/> 39917	<input checked="" type="checkbox"/> 39918	2× Ø 8 mm	10	
KT 4 2	<input type="checkbox"/> 39937	<input checked="" type="checkbox"/> 39938	4× Ø 2 mm	10	
KT 4 3	<input type="checkbox"/> 39914	<input checked="" type="checkbox"/> 39915	4× Ø 3 mm	10	
KT 4 4	<input type="checkbox"/> 39909	<input checked="" type="checkbox"/> 39911	4× Ø 4 mm	10	
KT 4 5	<input type="checkbox"/> 39908	<input checked="" type="checkbox"/> 39910	4× Ø 5 mm	10	
KT 4 6	<input type="checkbox"/> 39932	<input checked="" type="checkbox"/> 39933	4× Ø 6 mm	10	
KT-ASI	<input type="checkbox"/> 39902	<input checked="" type="checkbox"/> 39903	1 ASI-cable	10	 KT ASI2 rI
KT-ASI2 rI	<input type="checkbox"/> 39922	<input checked="" type="checkbox"/> 39924	2 ASI-cables	10	
KT-ASI2 rII	<input type="checkbox"/> 39921	<input checked="" type="checkbox"/> 39923	2 ASI-cables	10	

## Product description

KT cable inserts small are used with the following cable entry frames:

- KEL(-ER) | Page 6 - 14
- KEL-FG | Page 18 - 19
- KVT | Page 22 - 25
- KVT-W90 | Page 26

The model range KT small is designed for cable diameters from 2 to 17 mm.

## Assembly

When installing the insert, the smooth side of the insert faces the middle of the cable entry frame.

### Specification KT grey

Material **Elastomer**  
 Flame class **UL94-Vo, self-extinguishing**  
 Temperature **- 40°C to+ 90°C (static)**  
 Properties **Halogen-free, silicone-free**

### Specification KT black

Material **Elastomer**  
 Flame class **UL94-HB**  
 Temperature **- 30°C to+ 90°C (static)**  
 Properties **Higher chemical resistance, UV-stabilized**